



FLEXIAGENT

Market Leading, Independent Estate Agents



Stamford Road

Southport, PR8 4ET

Offers In Excess Of £150,000

Flexi-Agent are delighted to present this three-bedrooms semi-detached property to the open market. Located in the sought-after area of Birkdale, within walking distance of the vibrant Birkdale Village with its plethora of shops, restaurants and bars, it is surrounded by a wealth of local amenities and is a stone's throw from excellent local transport links and great local schools. Available for purchase with NO ONWARDS CHAIN.

The property briefly comprises: Entrance porch, living room, a modern fitted kitchen, a utility room and a downstairs bathroom.

The first floor consists of three well-proportioned bedrooms.

Externally the property benefits from driveway parking and a sun-catching rear garden.

Viewings are available upon request.

NO CHAIN
Freehold
Council Tax Band A
EPC D

Viewing

Please contact our Flexi Agent Southport Office on 01704 889455 if you wish to arrange a viewing appointment for this property or require further information.

- Three bedrooms
- Semi detached, circa 908 sqft
- NO CHAIN
- Front living room
- Modern kitchen
- Three piece bathroom
- Walking distance to Birkdale village
- Driveway parking
- Rear sun catching garden
- Viewings available upon request



Floor Plan

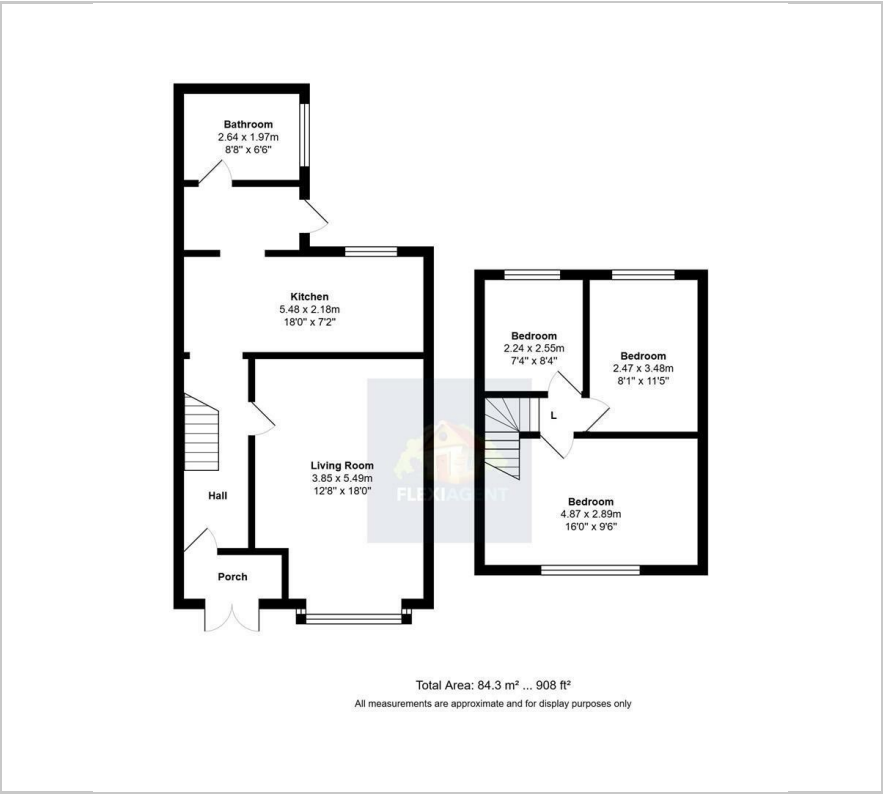

Area Map



Energy Efficiency Graph

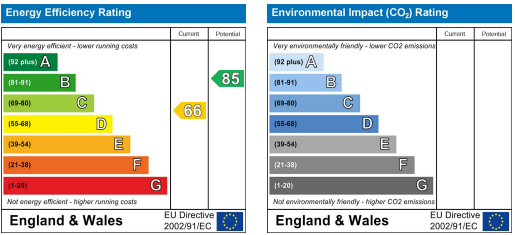

These particulars, whilst believed to be accurate are set out as a general outline only for guidance and do not constitute any part of an offer or contract. Intending purchasers should not rely on them as statements of representation of fact, but must satisfy themselves by inspection or otherwise as to their accuracy. No person in this firms employment has the authority to make or give any representation or warranty in respect of the property.